

4 Tier Industrial Wire Shelving Rack - Black

Vendor Stock# 4T1848B

Assembly Instructions

Questions, Problems, Missing Parts?

Before returning to your retailer, CALL OUR CUSTOMER SERVICE DEPARTMENT at
1-866-375-7994, 9 a.m. - 5 p.m. EST. MONDAY- FRIDAY or E-Mail: sales@shelfadditions.com

PACKAGE CONTENTS

A - Shelf x 4



B - Top Pole x 4
Pole Cap & Connector Pre-installed

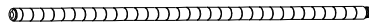

C - Bottom Pole x 4
Bottom Pole Insert Pre-installed



D - Plastic Tapered Lock x 32 + extra 4

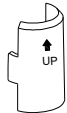

E - Caster x 2

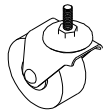

F - Locking Caster x 2

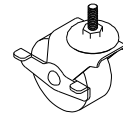

G - Feet Leveler x 4

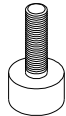

H - Caster Wrench x 1

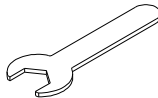

I - Shelf Liner x 4

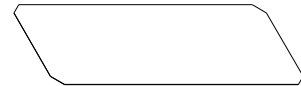

No tools required for assembly. Helpful - Rubber Mallet

Note: White plastic discs between each shelf collar are for packing only – Discard

SPECIAL WARNINGS



Assemble the item on a soft, non-abrasive surface, such as carpeting, to avoid scratching the finish.
Use care when handling. May require two adults for safe assembly.

CARE AND MAINTENANCE

Periodically check and make sure that all components are in their proper position, are free from damage and that all connectors are tight.



Each shelf holds up to Max. 600 lbs evenly distributed with feet leveler.
Total unit holds up to Max. 500 lbs with casters evenly distributed.

1-YEAR LIMITED WARRANTY

The manufacturer warrants this product to be free from defects in workmanship and material present at time of shipment from the factory for one year from the date of purchase. This warranty applies only to the original purchaser. The manufacturer agrees to correct such defect at no charge or at our option replace the product with a comparable or superior model.

To obtain warranty service, call our customer service department at 1-866-375-7994 for return authorization and shipping instructions. You may be required to present a copy of your sales receipt as proof of purchase. All cost of removal and reinstallation are the expressed responsibility of the purchaser. Any damage to the product by accident, misuse or improper installation, or by affixing accessories not produced by the manufacturer, are the purchaser's responsibility.

There is no further expressed warranty. The manufacturer disclaims any and all implied warranties. The manufacturer shall not be liable for incidental, consequential or special damages arising at or in connection with product use or performance except as may otherwise be accorded by law. This warranty gives you specific legal rights and you also have other rights that vary from state to state. This warranty supersedes all prior warranties.

Option 1: Feet Leveler If Required

Option 2: Casters If Required

